

# 11 WETHERED PARK

*Magazine* ➤



THE  
COUNTRY  
HOUSE  
DEPT.





# 11 *Wethered Park*

Marlow, Buckinghamshire, SL7 2BH



Tucked discreetly behind a gated entrance, 11 Wethered Park reveals a quietly confident townhouse, moments from Marlow's vibrant High Street yet immersed in the calm of its private setting. Arranged over three elegant floors, the house unfolds with a natural sense of flow, where two generous reception rooms, on both ground and first floors frame uninterrupted views across the surrounding parkland. Everyday living is thoughtfully considered, from the bespoke fitted home office to the well-appointed kitchen and utility. Three beautifully proportioned bedrooms are complemented by four bathrooms, offering both flexibility and comfort. Outside, a private garden extends the living space, while residents also enjoy expansive communal grounds, alongside the ease of driveway parking and a double garage.







# THE FINER *Details*

**Bedrooms**  
3

**Reception Rooms**  
3

**Bath/Shower Rooms**  
4

**Study**  
1

**Double Garaging**

**What3Words**  
///Satin.crystals.hears

**Co-Ordinates**  
51°34'08"N , 000°46'49"W

**Services**  
Mains water, electricity, and drainage  
Gas fired central heating

**EPC**  
Band C

**Council Tax**  
Band G

**Local Authority**  
Buckinghamshire Council













## ABOUT THIS *Area*



Wethered Park is Marlow's most exclusive gated enclave, where landscaped parkland and elegant homes create a peaceful, private setting just a short, level stroll from the High Street and picturesque riverside. Both prominent riverside market towns of Marlow and Henley-on-Thames offer an excellent range of shopping and recreational facilities with more extensive facilities available at Maidenhead, Reading and Oxford.

The Chiltern Hills, an Area of Outstanding Natural Beauty, occupy the south of the county of Buckinghamshire and offer the most breathtaking scenery and outdoor activities.

There are a number of golf courses locally including Temple, Harleyford and Henley-on-Thames. The area is renowned for quality education, Marlow offers prep schools to secondary schools, such as Sir William Borlase's Grammar School and Great Marlow School. Marlow has a train service via the Elizabeth Line to Paddington with fast trains also accessible from High Wycombe providing a 25-minute journey into London Marylebone. The M40/M4 motorways are accessed from the A404 which passes the town.











NOTICE  
This hedge is the property of the  
National Trust and is protected by  
law. No part of it may be cut or  
damaged without the permission of  
the National Trust.





# POINTS OF *Interest*



## **Towns and Cities**

Marlow 0.6 miles  
Henley on Thames 5.3 miles  
Beaconsfield 7 miles  
Central London 34 miles

## **Pubs & Restaurants**

The Hand and Flowers, Marlow  
Cliveden House, Cliveden  
The Waterside Inn, Bray

## **Train Stations**

Marlow Station 0.6 miles  
(London Paddington from 46 mins)  
Maidenhead Station  
(London Paddington from 24 mins)  
Beaconsfield Station miles  
(London Marylebone from 22 mins)

## **Airports**

London Heathrow Airport 16 miles  
London Gatwick Airport 56 miles  
London Stanstead Airport 68 miles



# FLOORPLANS

## *11 Wethered Park*

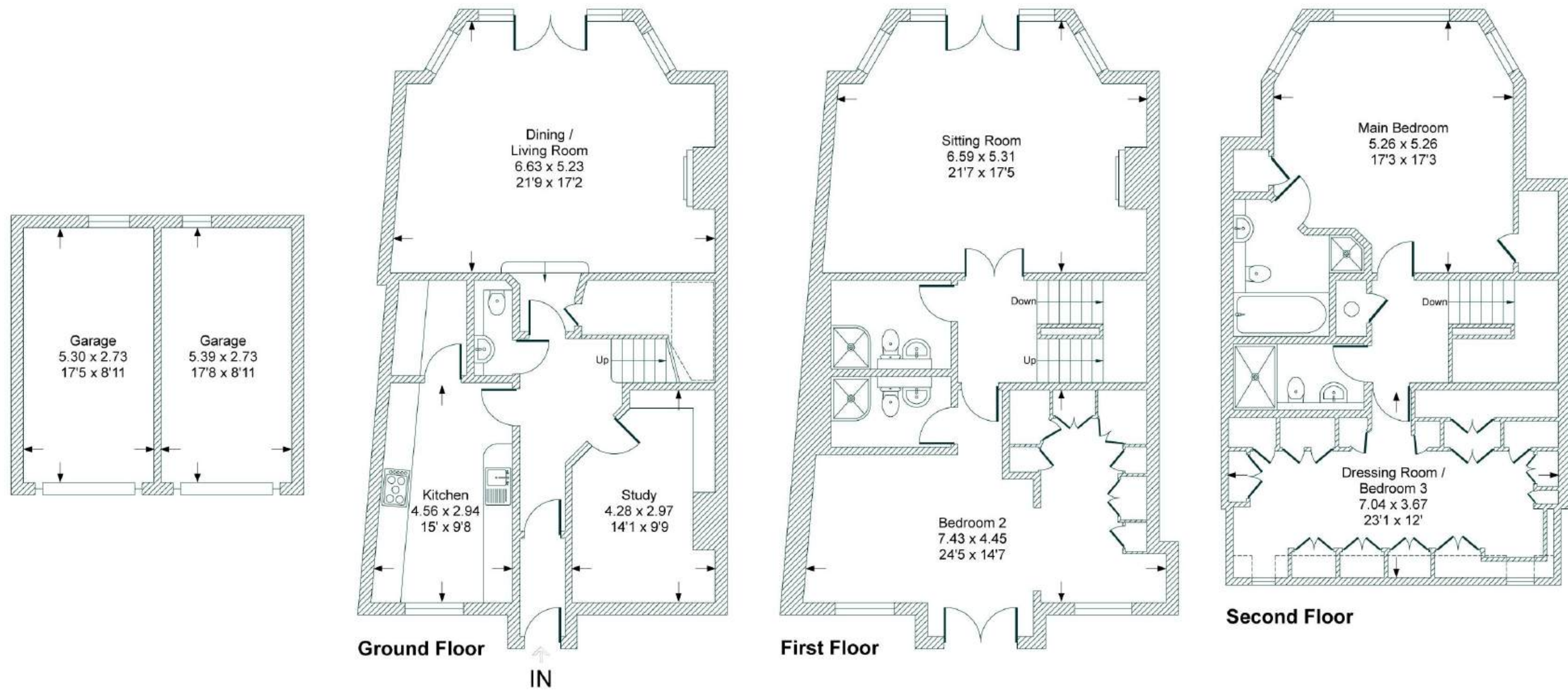

Total - 260.8 sq m / 2,808 sq ft  
House - 231.2 sq m / 2,489 sq ft | Garage - 29.6 sq m / 319 sq ft

# AREA GUIDE

## *Buckinghamshire* ➡

With its chocolate box villages, historic towns, quality attractions and stunning countryside along with its cosy pubs, Buckinghamshire is formed partly by Chiltern landscapes that inspired literary residents and has a rich sporting heritage. There are lots of things to do in Buckinghamshire. Walk in Roald Dahl's footsteps through medieval villages to historic coaching inns. Or nose in drawing rooms in Italianate mansions, the backdrop for scandals like the Profumo Affair. This colourful southeast county has a high-octane side. Formula One cars rev on Grand Prix circuits and crews of rowers paddle on Olympic rowing lakes. Buckinghamshire has something for everyone.

### **Walking - The Chiltern Way**

The Chiltern Way is a route of 134 miles through Bedfordshire, Buckinghamshire, Hertfordshire & Oxfordshire and offers breath taking views of the rolling landscape.

### **Eating Out - The Mash Inn, Bennett End**

A restaurant with rooms located in the hamlet of Bennett End. The small restaurant features an open kitchen where they cook simply but skillfully over a bespoke wood-fired grill.

### **Event - The British Grand Prix**

Home of the British Grand Prix, the Silverstone circuit straddles the Northamptonshire / Buckinghamshire boarder.

### **Day Out - Waddesdon Manor**

Built by Baron Ferdinand de Rothschild to exhibit his collections of art treasures. The Victorian garden is considered one of the finest in Britain.





THE  
COUNTRY  
HOUSE  
DEPT.



03332 340 901  
[info@thecountryhousedepartment.com](mailto:info@thecountryhousedepartment.com)  
[thecountryhousedepartment.com](http://thecountryhousedepartment.com)

**IMPORTANT NOTICE:** The Country House Department gives notice that: 1. These particulars do not constitute an offer or contract or part thereof. 2. All descriptions, photographs and plans are for guidance only and should not be relied upon as statements or representations of fact. All measurements are approximate and not necessarily to scale. Any prospective purchaser must satisfy themselves of the correctness of the information within the particulars by inspection or otherwise. 3. The Country House Department does not have any authority to give any representations or warranties whatsoever in relation to this property (including but not limited to planning/building regulations), nor can it enter into any contract on behalf of the Vendor. 4. The Country House Department does not accept responsibility for any expenses incurred by prospective purchasers in inspecting properties which have been sold, let or withdrawn. 5. The property will be sold subject to and with the benefit of all wayleaves, covenants, easements and rights of way, whether mentioned in these particulars or not. Photographs taken April 2026. Particulars prepared in April 2026.